

stambena zgrada Po+Pr+3+Pk, ulica Okrugićeva 21, Petrovaradin

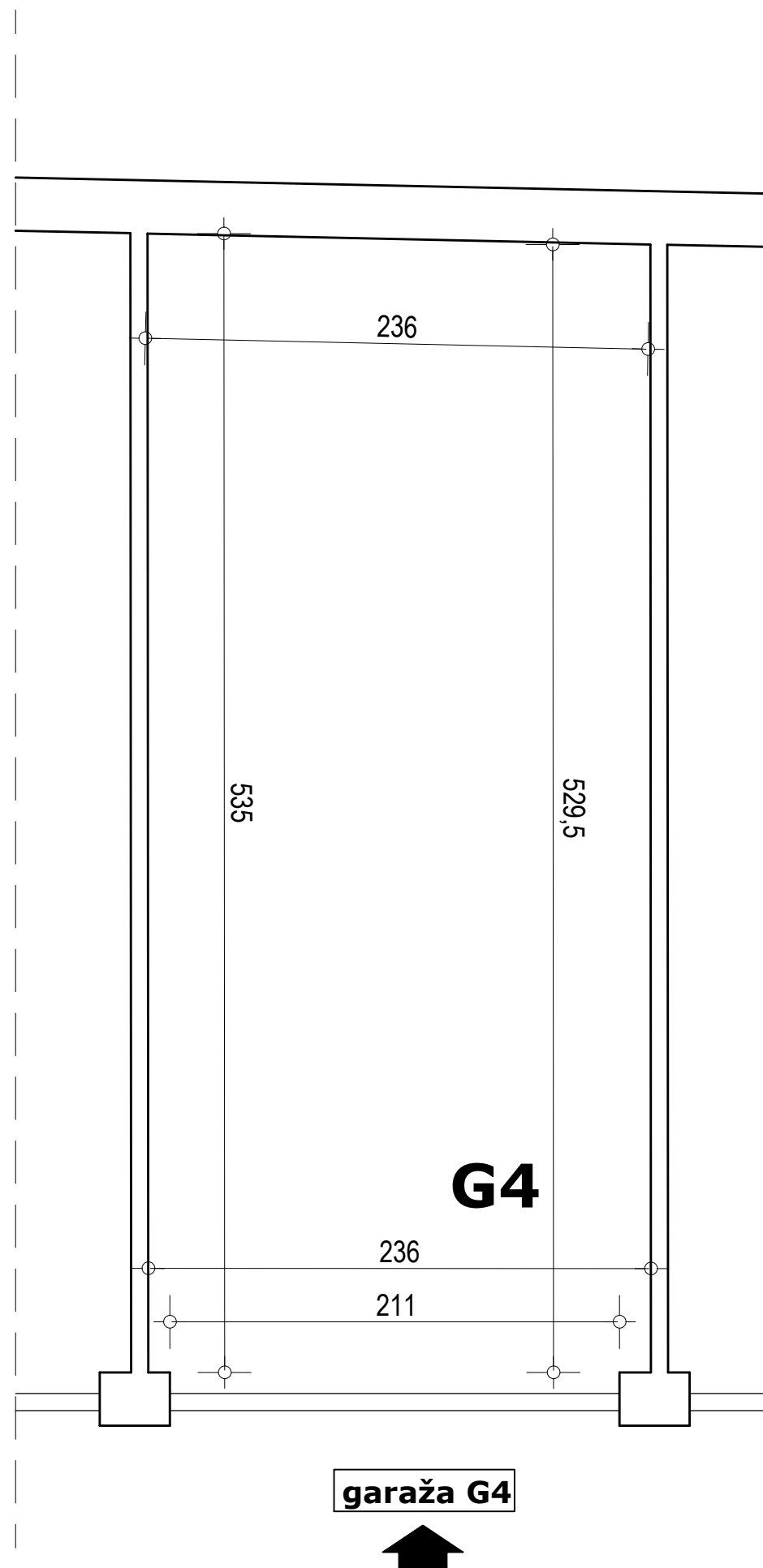

napomena: moguća su minimalna odstupanja usled postavljanja konstruktivnih elemenata i instalacionih vertikalna



GARAŽE

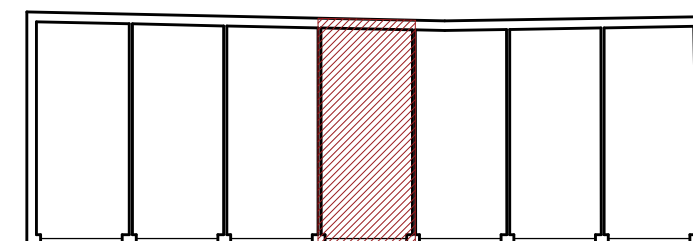
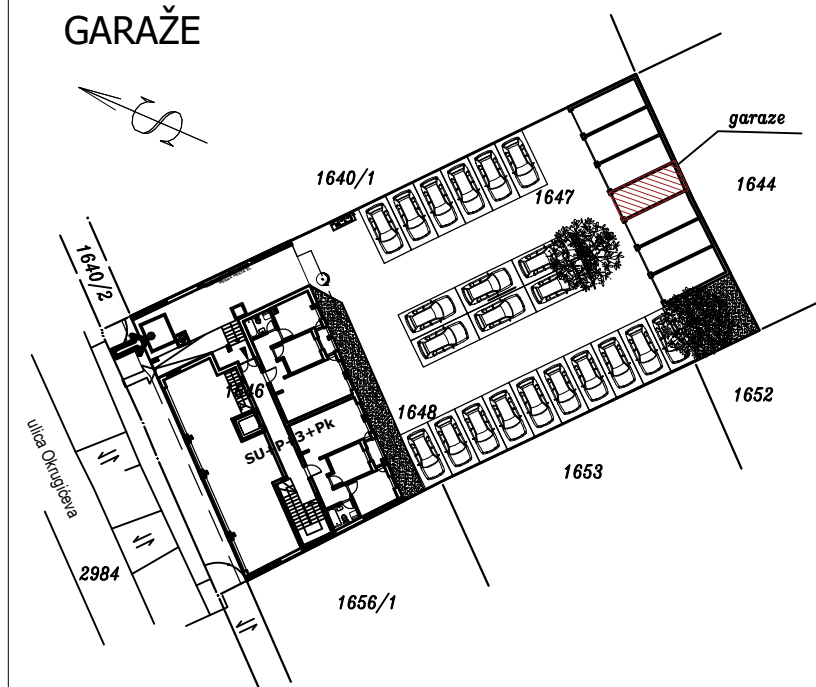

| BR. | NAZIV PROSTORIJE | VRSTA PODA | POVRŠINA PODA | KOEF. | KORISNA POVRŠINA |
|-----------------------|------------------|--------------|----------------------|-------|----------------------|
| G4 | Garaža | ker. pločice | 12.56 m ² | 0.97 | 12.18 m ² |
| Ukupno bez koef.: | | | | | 12.56 m ² |
| Ukupno sa koef. 0.97: | | | | | 12.18 m ² |